



CENTRAL DARLING SHIRE COUNCIL

Delegated report for internal determination

Development application

DA number	D/22/21- PAN 159157	Date of lodgement	16/11/2021
Applicant	James Golsworthy		
Owner	The National Parks Wildlife Services		
Proposed development	Construction of a Depot shed		
Street address	3 Woore Street/ McIntyre Street Wilcannia NSW 2836		
Notification period	28 days	Number of submissions	0

Assessment

Report prepared by	Glenda Dunn - Senior Planner
Report date	17 December 2021
Recommendation	Approved subject to conditions

Checklist

Summary of section 4.15 matters

Have all recommendations in relation to relevant section 4.15 matters been summarised in the Executive summary of the assessment report? Yes

Legislative clauses requiring consent authority satisfaction

Have relevant clauses in all applicable environmental planning instruments, where the consent authority must be satisfied about a particular matter, been listed and relevant recommendations summarised in the Executive Summary of the assessment report? Yes

Clause 4.6 Exceptions to development standards

If a written request for a contravention to a development standard (clause 4.6 of the LEP) has been received, has it been attached to the assessment report? N/A

Special Infrastructure Contributions

Does the DA require Special Infrastructure Contributions conditions (section 7.24)? N/A

Native Title land Claim and Aboriginal land claim

Review status N/A



Contents

1	Executive summary	4
2	Location	4
3	Site description	4
4	Background.....	4
5	The proposal.....	4
6	Assessment against planning controls	4
7	Key issues	5
8	Issues raised by the public	5
9	External referrals	5
10	Internal referrals.....	5
11	Conclusion	5
12	Political donations disclosure.....	5
13	Recommendation.....	6
	Proposed Development.....	15
	Assessment.....	15
	Consultation	18
	Financial Contributions.....	18
	Recommendation	18
	APPROVED DEVELOPMENT	19
	SCHEDULE 2.....	22
1	PROTECTION OF ADJOINING AREAS	22
2	NOISE – COMMERCIAL PLANT / INDUSTRIAL DEVELOPMENT	22
3	ASBESTOS REMOVAL WORKS	23
4	WASTE AND RECYCLING MANAGEMENT - MINOR	24
5	RUN – OFF AND EROSION CONTROLS.....	24
	SCHEDULE 2B	24
6	OCCUPATION CERTIFICATE TO BE SUBMITTED.....	24
7	HOURS OF WORK AND NOISE	25
8	NOISE – DURING CONSTRUCTION	25
9	ENCROACHMENTS – NEIGHBOURING PROPERTIES	25
10	DEMOLITION	25
11	MAINTENANCE OF SITE.....	26
12	EARTHWORKS, RETAINING WALLS AND STRUCTURAL SUPPORT	26
13	ARCHAEOLOGY DISCOVERED DURING WORKS	26



14	ABORIGINAL OBJECTS DISCOVERED DURING WORKS.....	27
15	COVERING OF LOADS	27
16	LOADING AND UNLOADING DURING CONSTRUCTION	27
17	NO OBSTRUCTION OF PUBLIC WAY	27
18	USE OF MOBILE CRANES.....	28
19	CONTAMINATED SOILS	28
20	VEHICULAR ACCESSS.....	28
21	UTILITY SERVICES	29

Attachments

- 1 Location map - zone information, Aerial image
- 2 Plans
- 3 Assessment against planning controls
- 4 Draft conditions of consent

1 Executive summary

1.1 The key issues that need to be considered in respect of this application are:

The construction of a shed for the National Parks Depot in Wilcannia.

Assessment of the application against the relevant planning framework and consideration of matters by our technical departments has not identified any issues of concern that cannot be dealt with by conditions of consent.

The application is therefore satisfactory when evaluated against Section 4.15 of the *Environmental Planning and Assessment Act 1979* (as amended).

This report recommends approval of the application subject to the recommended conditions.

2 Location

2.1 The site is located 3 Woore Street/ McIntyre Street Wilcannia NSW 2836.

2.2 The location of the site is shown at attachment 1.

3 Site description

3.1 Lot 7 Section 10 DP 759091.

3.2 An aerial image of the site and surrounding area is at attachment 1.

4 Background

4.1 IN2 Light Industrial zone - The zoning plan for the site and surrounds is at attachment 1.

4.2 The lot is not a local heritage item

5 The proposal

5.1 The development application has been lodged by Mr James Golsworthy on behalf of The National Park Wildlife Services.

The applicant proposes the construction of a shed for the National Parks Depot in Wilcannia.

6 Assessment against planning controls

6.1 A full assessment of the development application against relevant planning controls is provided in the attachments, including:

- Environmental Planning and Assessment Act 1979 (as amended 2018)
- Central Darling Local Environmental Plan 2012

7 Key issues

The construction of a shed for the National Parks Depot in Wilcannia.

8 Issues raised by the public

- 8.1 The proposed development was notified to property owners and occupiers in the locality for 28 days upon the council website.
- 8.2 Council received 0 submissions.

9 External referrals

- 9.1 The development application was referred to the following external authorities for comment:

Authority	Comments
0	0

10 Internal referrals

- 10.1 The development application was referred to the following internal sections of Council for comment:

Section	Comments
0	0

11 Conclusion

The proposed development has been assessed against all relevant matters and is considered to be satisfactory. It is considered that the likely impacts of the development have been satisfactorily addressed and that the proposal is in the public interest. The site is considered suitable for the proposed development subject to conditions.

12 Political donations disclosure

- 12.1 Under Section 10.4 of *the Environmental Planning and Assessment Act 1979*, a disclosure statement must be lodged in certain circumstances in relation to any planning application, i.e. a development application, an application to modify a consent and an application to make an environmental planning instrument or development control plan.
- 12.2 A disclosure statement of a reportable political donation or gift must accompany a planning application or submission (including a submission either objecting to or supporting the proposed development) if the donation or gift is made within 2 years before the application or submission is made. If the donation or gift is made after the lodgement of the application, a disclosure statement must be sent to Council within 7 days after the donation or gift is made. The provision also applies to an associate of a submitter.

12.3 A disclosure statement may be made available for viewing upon a written request to Council in line with Section 12 of the *Local Government Act 1993*.

As required under Section 10.4 of the Act, a disclosure statement has been submitted to Council in respect of the subject development application.

13 Recommendation

Approve Development Application D/22/21- PAN 159157 at 3 Woore Street/ McIntyre Street Wilcannia NSW 2836, for the reasons listed below, and subject to the conditions listed in the attachments.

- a The construction of a shed for the National Parks Depot and ancillary works in Wilcannia
- 2 Council officers to notify the applicant and submitters of the decision.



Glenda Dunn
Senior Planner



Reece Wilson
Director Shire Services

ATTACHMENT 1 - MAPS and PHOTOS

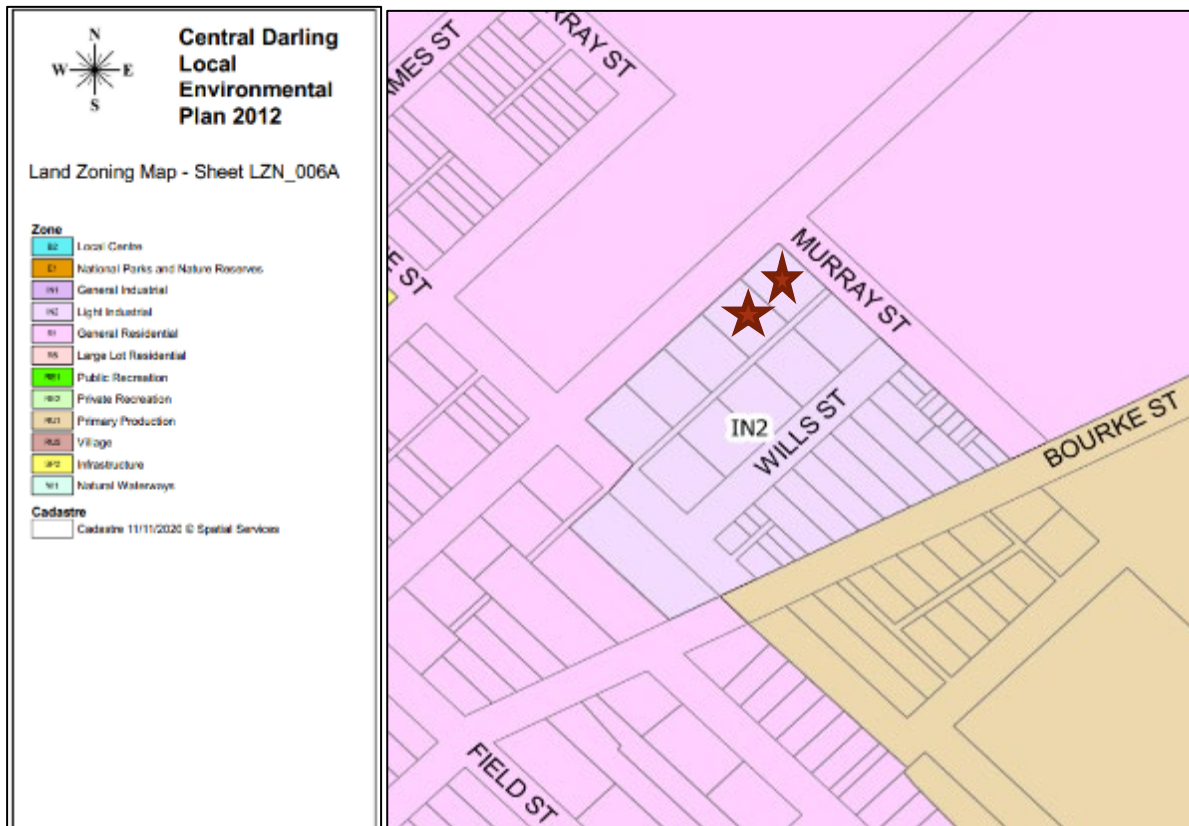

Figure 1: 3 Woore Street/ McIntyre Street Wilcannia NSW 2836 (source: Central Darling LEP 2012 zone map).



Figure 2 - 3 Woore Street/ McIntyre Street Wilcannia NSW 2836 (Source: 6 maps 2021).



Photo: aerial photo of site at 3 Woore Street/ McIntyre Street Wilcannia NSW 2836 (Source: 6 maps 2021)



Photo: photo of site 3 Woore Street/ McIntyre Street Wilcannia NSW 2836 (Source: google streetmaps 2021)



Photo of location of 3 Woore Street/ McIntyre Street Wilcannia NSW 2836 (source google streetmaps 2021)

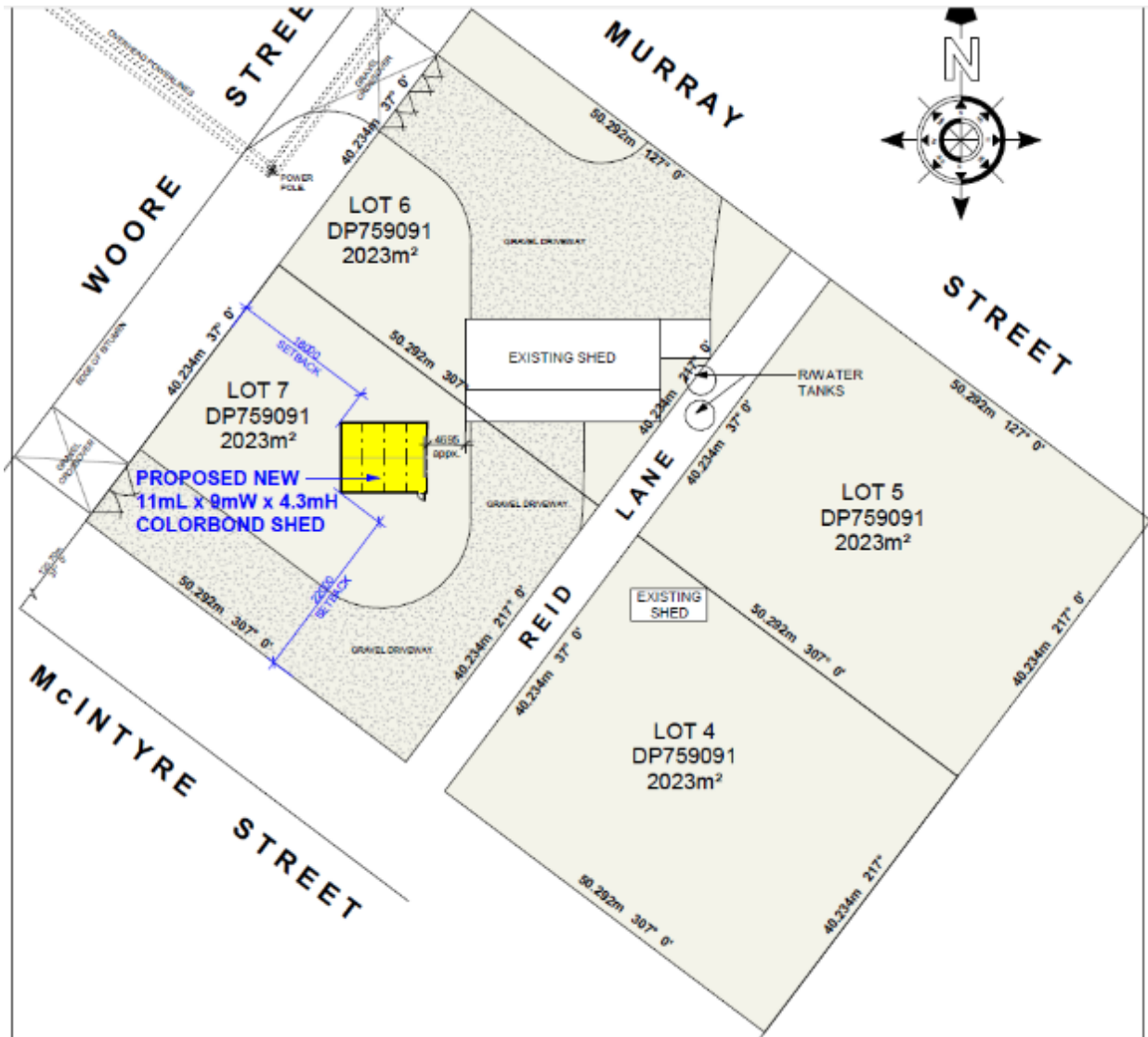

Site plan for the proposed new shed at the National parks depot.- 3 Woore Street/ McIntyre Street Wilcannia NSW 2836 (source Golsworthy Consultants SEE 2021)



**PROPOSED NEW
11mL x 9mW x 4.3mH
COLORBOND SHED
for
NSW NATIONAL PARKS &
WILDLIFE SERVICES**

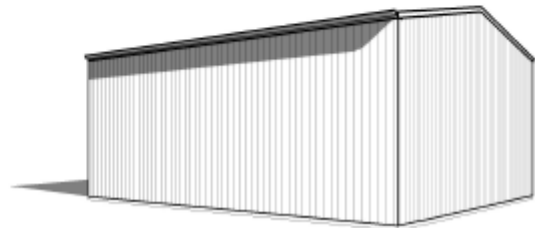
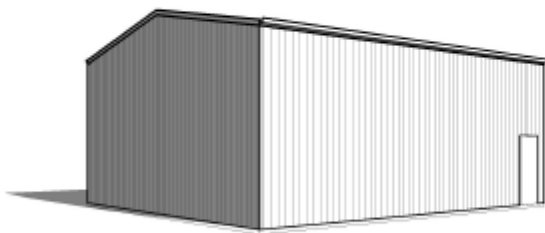
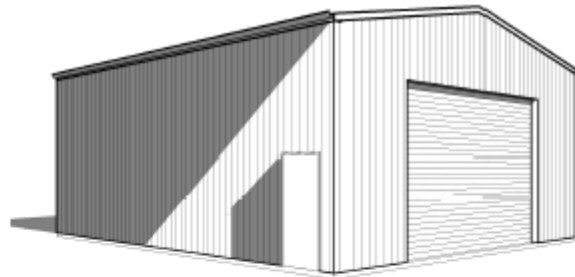
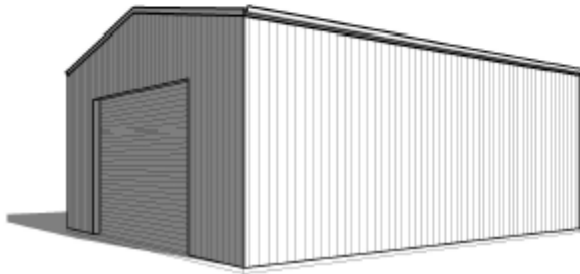

Example of the 3 Woore Street/ McIntyre Street Wilcannia NSW 2836 ((source Golsworthy Consultants SEE 2021)

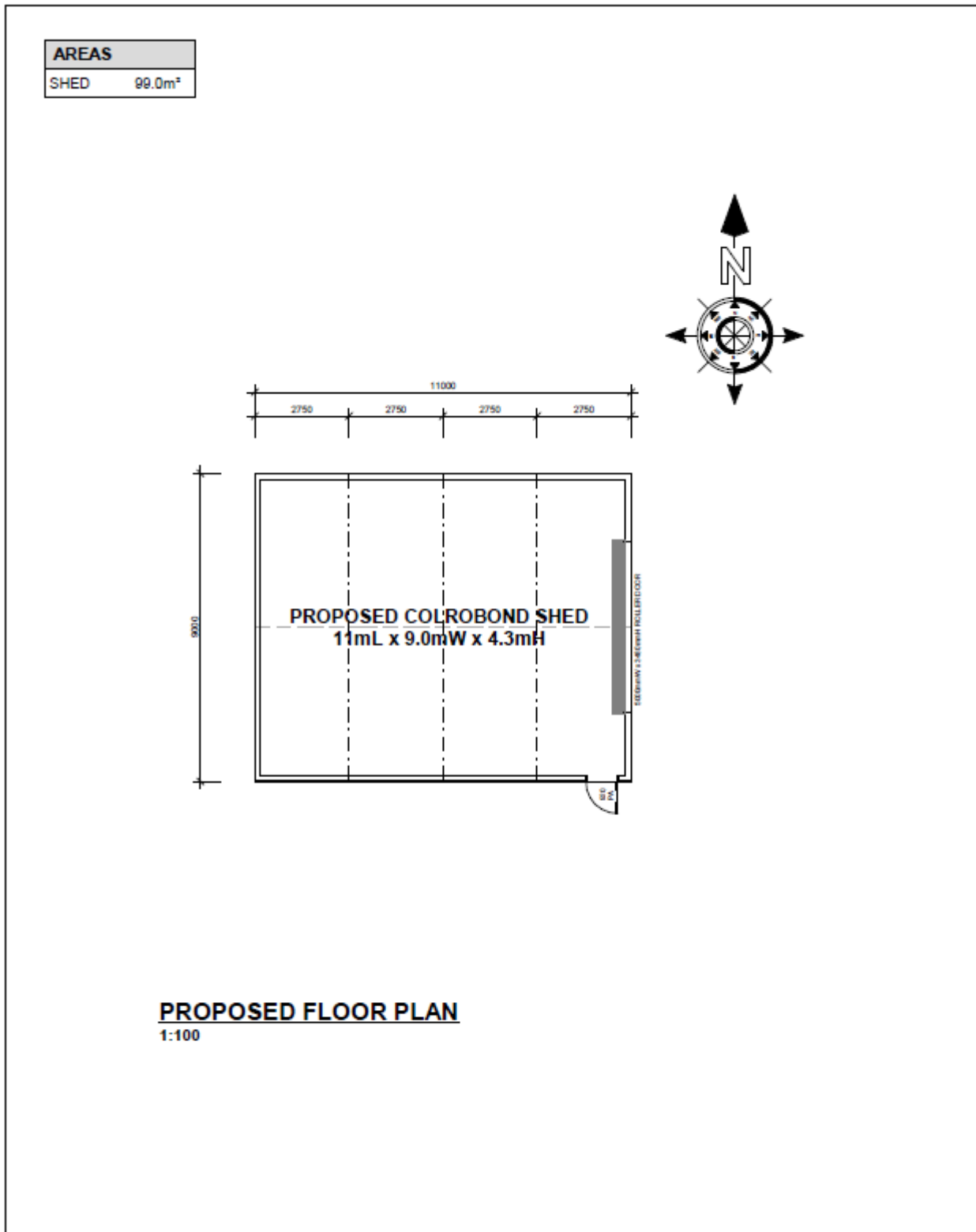

Site plan of the 3 Woore Street/ McIntyre Street Wilcannia NSW 2836 (source Golsworthy Consultants SEE 2021)

ATTACHMENT 2 - ASSESSMENT OF PLANNING CONTROLS

PLANNING ASSESSMENT SUMMARY

Application Number:	D/22/21- PAN 159157
Site Address:	3 Woore Street/ McIntyre Street Wilcannia NSW 2836
Date of Lodgement:	30 08 2021
Applicant:	James Golsworthy - The National Parks Wildlife Services
Architect/Designer:	
Owner:	The National Parks Wildlife Services
Cost of Works:	\$60,000.00
Development Contribution Required:	No
Zoning:	IN2 Light Industrial zone
Proposal:	Construction of a Depot shed
Recommendation:	The development application is recommended for approval, subject to the conditions in the Notice of Determination.

Background

The Site and Surrounding Development

The site is situated within the established light industrial zone of Wilcannia which is bordered by McIntyre Street, Bourke Street, Murray Street and Woore Street Wilcannia on the north eastern side of Wilcannia.

The subject site is located at 3 Woore Street/ McIntyre Street Wilcannia NSW 2836. The total site area of 1,329ha. The site has a frontage width on Ross Street Wilcannia. The site slopes towards the west of the site.

Proposed Development

The application seeks consent for the following:

The construction of a depot shed for National Parks and ancillary works.

Assessment

The proposed development has been assessed under Section 4.15 of the Environmental Planning and Assessment Act 1979 (EP&A Act).

Local Environmental Plans

Central Darling Local Environmental Plan 2012

An assessment of the proposed development against the relevant provisions of the Central Darling Local Environmental Plan 2012 is provided in the following sections.

Part 2 Permitted or prohibited development

Provision	Compliance	Comment
2.3 Zone objectives and Land Use Table	Yes	<p>Zone IN2 Light Industrial</p> <p>1 Objectives of zone</p> <ul style="list-style-type: none"> • To provide a wide range of light industrial, warehouse and related land uses. • encourage employment opportunities and to support the viability of centres. • To minimise any adverse effect of industry on other land uses. • To enable other land uses that provide facilities or services to meet the day to day needs of workers in the area. • support and protect industrial land for industrial uses. <p>2 Permitted without consent Environmental protection works; Roads; Water reticulation systems</p> <p>3 Permitted with consent Depots; Funeral homes; Garden centres; Hardware and building supplies; Industrial training facilities; Kiosks; Heliports; Landscaping material supplies; Light industries; Neighbourhood shops; Oyster aquaculture; Places of public worship; Rural supplies; Take away food and drink premises; Tank-</p>

		<p>based aquaculture; Timber yards; Vehicle sales or hire premises; Warehouse or distribution centres; Any other development not specified in item 2 or 4</p> <p>4 Prohibited Agriculture; Air transport facilities; Airstrips; Amusement centres; Biosolids treatment facilities; Camping grounds; Caravan parks; Cemeteries; Centre-based child care facilities; Commercial premises; Crematoria; Eco-tourist facilities; Educational establishments; Entertainment facilities; Exhibition homes; Exhibition villages; Farm buildings; Forestry; Function centres; General industries; Health services facilities; Heavy industrial storage establishments; Heavy industries; Home-based child care; Home businesses; Home occupations; Home occupations (sex services); Information and education facilities; Marinas; Mooring pens; Moorings; Open cut mining; Pond-based aquaculture; Public administration buildings; Registered clubs; Residential accommodation; Resource recovery facilities; Respite day care centres; Rural industries; Sewage treatment plants; Tourist and visitor accommodation; Waste disposal facilities; Wharf or boating facilities</p>
--	--	---

Principal development standards

Provision	Compliance	Comment
4.3 Height of buildings	Yes	No height limit. Structure - 5.2 metres high depot shed
4.4 Floor space ratio	Yes	No FSR for site Floor area is 99m ² .
Bushfire prone land	Yes	Bushfire prone land - Vegetation Category 3.

General Provisions

Provision	Compliance	Comment
Public Domain	Yes	The proposed works will not result in any overshadowing or impact on the surrounding industrial area of adjoining residential area. The depot shed will not impact on the public domain or affect public views.

Heritage	Yes	There is no impact on any heritage item.
Transport and Parking	Yes	Not applicable. No car parking required.
3.12 Accessible Design	Yes	Not applicable depot shed for equipment - national parks
3.14 Waste	Yes	Not applicable - exiting waste disposal methods still apply

Development Types

Provision	Compliance	Comment
4.2.1 Building height		
4.2.1.2 Floor heights	Yes	The building is at ground level.
4.2.2 Building setbacks	N/A	The building is setback from all of the sites boundaries (2 lots owned by National parks). 18m setback from front boundary, 22m setback from side boundary and 18.05m from rear lane boundary.
4.2.3 Amenity		
4.2.3.1 Solar access	Yes	Not applicable No adjacent neighbours to be affected
4.2.3.11 Acoustic privacy	Yes	Not applicable No adjacent neighbours to be affected
4.2.6 Waste and recycling Management	Yes	A Waste Management Plan is not required Normal waste procedure applies.

Consultation

Internal Referrals

The application was not discussed with any internal units.

Advertising and Notification

The application was advertised on the Central Darling Website for 28 days, there was no submissions.

Financial Contributions

N/A

Conclusion

The proposed national parks depot shed is wholly within the national parks allotment within the Wilcannia light industrial area.

There is no impact on the adjoining light industrial area and the adjoining residential area.

Having regards to all of the above matters, the proposed development will not result in any adverse impacts on both the natural and built environment and the locality, is suitable for the site, and is in the public interest, subject to appropriate conditions of consent being imposed.

The proposed development generally satisfies the relevant provisions of the applicable State Environmental Planning Instruments including the Central Darling Local Environmental Plan 2012 and is acceptable.

Recommendation

The development application is recommended for approval, subject to the conditions in the Notice of Determination.

The application is approved under delegated authority of Council.

ATTACHMENT 3- CONDITIONS OF CONSENT

APPROVED DEVELOPMENT

Development for the National Parks depot shed must be in accordance with Development Application No. D22/21 PAN 138023 3 Woore Street/ McIntyre Street Wilcannia NSW 2836, dated 15/09/2021 and the drawings as amended by the conditions of this consent.

In the event of any inconsistency between the approved plans and supplementary documentation, the plans will prevail.

Prescribed Conditions

All building works must be carried out in accordance with the requirements of the Building Code of Australia (BCA).

A sign must be erected in a prominent position on any site on which building work, subdivision work or demolition work is being carried out:

The sign is to show the name, address and telephone number of the Principal Certifying Authority for the work, and

The sign is to show the name of the principal contractor (if any) for any building work and a telephone number on which that person may be contacted outside working hours, and

The sign is to state that unauthorised entry to the work site is prohibited.

Any such sign is to be maintained while the building work, subdivision work or demolition work is being carried out, but must be removed when the work has been completed.

Residential building work within the meaning of the Home Building Act 1989 must not be carried out unless the Principal Certifying Authority for the development to which the work relates (not being the Council) has given the Council written notice of the following information:

*in the case of work for which a principal contractor is required to be appointed:

*the name and licence number of the principal contractor, and

*the name of the insurer by which the work is insured under Part 6 of that Act,

*in the case of work to be done by an owner-builder:

*the name of the owner-builder, and

*if the owner-builder is required to hold an owner-builder permit under that Act, the number of the owner-builder permit.

Development that involves an excavation that extends below the level of the base

*of the footings of a building on adjoining land, the person having the benefit

*of the development consent must, at the person's own expense:

*protect and support the adjoining premises from possible damage from the excavation, and

*where necessary, underpin the adjoining premises to prevent any such damage.

*must, at least 7 days before excavating below the level of the base of the footings of a building on an adjoining allotment of land, give notice of intention to do so to the owner of the adjoining allotment of land and furnish particulars of the excavation to the owner of the building being erected or demolished.

*the owner of the adjoining allotment of land is not liable for any part of the cost of work carried out for the purposes of this clause, whether carried out on the allotment of land being excavated or on the adjoining allotment of land.

In this clause, allotment of land includes a public road and any other public place.

Reason: Legislative requirement.

Schedule 1B - General Requirements

Unless authorised by Council:

Building construction and delivery of material hours are restricted to:

- I 7.00 am to 5.00 pm inclusive Monday to Friday,
- I 8.00 am to 1.00 pm inclusive on Saturday,
- I No work on Sundays and Public Holidays.

Demolition and excavation works are restricted to:

- I 8.00 am to 5.00 pm Monday to Friday only.

Mandatory Critical Stage Inspections.

The following applicable works shall be inspected and passed by an officer of Council prior to them being covered. In this regard, at least 24 hours notice shall be given to Council for inspection of such works. When requesting an inspection, please quote Council's reference number D22/21 PAN-159157.

Advanced notification for an inspection should be made by emailing or by telephoning Council's Development & Environment Division.

1. Inspection of footings and foundations (prior to placement / pour of concrete) - in accordance with Structural engineer drawings and design.
2. Inspection of slab - reinforcing steel work (prior to concrete pour).
3. Inspection of wall framework. - prior to cladding.
4. Inspection of roof framework.- prior to roof installation.
5. Internal and external sanitary plumbing and drainage under hydraulic test.
- 6.. Water plumbing including fire services, under hydraulic test.
7. Final inspection of the installed sanitary and water plumbing fixtures upon the building's completion prior to its occupation/use.

(Reason: Statutory compliance provision and Council requirement being the delegated Plumbing Regulator)

(Excavation work includes the use of any excavation machinery and the use of jackhammers, rock breakers, excavators, loaders and the like, regardless of whether the activities disturb or alter the natural state of the existing ground stratum or are breaking up/removing materials from the site).

Should any asbestos be uncovered on site, its demolition and removal must be carried out in accordance with WorkCover requirements and the relevant Australian Standards.

At all times after the submission the Notice of Commencement to Council, a copy of the Development Consent and Construction Certificate is to remain onsite at all times until the issue of a final Occupation Certificate. The consent shall

be available for perusal of any Authorised Officer.

Where demolition works have been completed and new construction works have not commenced within 4 weeks of the completion of the demolition works that area affected by the demolition works shall be fully stabilised and the site must be maintained in a safe and clean state until such time as new construction works commence.

Onsite toilet facilities (being either connected to the sewer or an accredited sewer management facility) for workers are to be provided for construction sites at a rate of 1 per 20 persons.

Prior to the release of the Construction Certificate, payment of the Long Service Levy is required. This payment can be made at Council or to the Long Services Payments Corporation. Payment is not required where the value of the works is less than \$25,000. The Long Service Levy is calculated on 0.35% of the building and construction work. The levy rate and level in which it applies is subject to legislative change. The applicable fee at the time of payment of the Long Service Levy will apply.

The applicant shall bear the cost of all works associated with the development that occurs on Council's property.

No skip bins, building materials, demolition or excavation waste of any nature, and no hoist, plant or machinery (crane, concrete pump or lift) shall be placed on Council's footpaths, roadways, parks or grass verges without Council Approval.

Demolition materials and builders' wastes are to be removed to approved waste/recycling centres.

No trees or native shrubs or understorey vegetation on public property (footpaths, roads, reserves, etc.) or on the land to be developed shall be removed or damaged during construction unless specifically approved in this consent including for the erection of any fences, hoardings or other temporary works.

Prior to the commencement of any development onsite for:

Building/s that are to be erected

Building/s that are situated in the immediate vicinity of a public place and is dangerous to persons or property on or in the public place

Building/s that are to be demolished

For any work/s that is to be carried out

For any work/s that is to be demolished

The person responsible for the development site is to erect or install on or around the development area such temporary structures or appliances (wholly within the development site) as are necessary to protect persons or property and to prevent unauthorised access to the site in order for the land or premises to be maintained in a safe or healthy condition. Upon completion of the development, such temporary structures or appliances are to be removed within 7 days.

A "Road Opening Permit" must be obtained from Council, and all appropriate charges paid, prior to commencement of any work on Council property. The owner/applicant shall be responsible for all public utilities and services in the area of the work, shall notify all relevant Authorities, and bear all costs associated with any repairs and/or adjustments as those Authorities may deem necessary.

The works must comply with the relevant Ausgrid Network Standards and SafeWork NSW Codes of Practice.

Requirements for new swimming pools/spas or existing swimming pools/spas affected by building works.

Child resistant fencing is to be provided to any swimming pool or lockable cover to

any spa containing water and is to be consistent with the following;

Relevant legislative requirements and relevant Australian Standards (including but not limited) to:

- Swimming Pools Act 1992
- Swimming Pools Amendment Act 2009
- Swimming Pools Regulation 2018
- Australian Standard AS1926 Swimming Pool Safety
- Australian Standard AS1926.1 Part 1: Safety barriers for swimming pools
- Australian Standard AS1926.2 Part 2: Location of safety barriers for swimming pools.
- A 'KEEP WATCH' pool safety and aquatic based emergency sign, issued by Royal Life Saving is to be displayed in a prominent position within the pool/spa area.
- Filter backwash waters shall be conveyed to the Sydney Water sewerage system in sewered areas or managed on-site in unsewered areas in a manner that does not cause pollution, erosion or run off, is separate from the irrigation area for any wastewater system and is separate from any onsite stormwater management system.
- Swimming pools and spas must be registered with the Division of Local Government.

Reason: To ensure that works do not interfere with reasonable amenity expectations of residents and the community.

SCHEDULE 2

PRIOR TO CONSTRUCTION CERTIFICATE/COMMENCEMENT OF WORK/HEALTH AND BUILDING

1 PROTECTION OF ADJOINING AREAS

- A temporary hoarding or temporary construction site fence must be erected between the work site and adjoining lands before the works begin and must be kept in place until after the completion of the works if the works.
- (a) could cause a danger, obstruction or inconvenience to pedestrian or vehicular traffic, or
 - (b) could cause damage to adjoining lands by falling objects, or
 - (c) involve the enclosure of a public place or part of a public place.

2 NOISE – COMMERCIAL PLANT / INDUSTRIAL DEVELOPMENT

Noise from commercial plant and industrial development must not exceed a project amenity/intrusiveness noise level or maximum noise level in accordance with relevant requirements of the NSW EPA Noise Policy for Industry 2017 (NPfI) unless agreed to by the Councils Director of Environmental Services. Further:

Background noise monitoring must be carried out in accordance with the long-term methodology in Fact Sheet B of the NPfI unless otherwise agreed by the Councils Director of Environmental Services.

Commercial plant is limited to heating, ventilation, air conditioning, refrigeration

and energy generation equipment.

3 ASBESTOS REMOVAL WORKS

All works removing asbestos containing materials must be carried out by a suitably licensed asbestos removalist duly licensed with Safework NSW, holding either a Friable (Class A) or a Non-Friable (Class B) Asbestos Removal Licence which ever applies.

A copy of the relevant licence shall be made available to any authorised Council officer on request within 24 hours.

Five days prior to the commencement of licensed asbestos removal, Safework NSW must be formally notified of the works. All adjoining properties and those opposite the development must be notified in writing of the dates and times when asbestos removal is to be conducted. The notification must identify the licensed asbestos removal contractor and include a contact person for the site together with telephone number and email address.

All work must be carried out in accordance with the Work Health and Safety Regulation 2017 and the NSW Government and SafeWork NSW document entitled How to manage and control asbestos in the workplace: Code of Practice (Safework NSW) December 2011 and associated guidelines.

The asbestos removalist must use signs and barricades to clearly indicate the area where the asbestos removal work is being performed. Signs must be placed in positions so that people are aware of where the asbestos removal work area is and should remain in place until removal is completed and clearance to reoccupy has been granted. Responsibilities for the security and safety of the asbestos removal site and removal must be specified in the asbestos removal control plan (where required). This includes inaccessible areas that are likely to contain asbestos.

Warning signs must be placed so they inform all people nearby that asbestos removal work is taking place in the area. Signs must be placed at all the main entry points to the asbestos removal work area where asbestos is present. These signs must be weatherproof, constructed of light-weight material and adequately secured so they remain in prominent locations. The signs must be in accordance with AS 1319 -1994 Safety Signs for the Occupational Environment for size, illumination, location, and maintenance.

Asbestos waste must only be transported and disposed of at an EPA licensed waste facility.

No asbestos products are to be reused on the site (i.e., packing pieces, spacers, formwork or fill etc).

No asbestos laden skips or bins are to be left in any public place without the written approval of Council.

A site notice board must be located at the main entrance to the site in a prominent position and must have minimum dimensions of 841mm x 594mm (A1) with any text on the notice to be a minimum of 30 point type size.

The site notice board must include the following:

- contact person for the site;
- telephone and facsimile numbers and email address; and
- site activities and time frames.

4 WASTE AND RECYCLING MANAGEMENT - MINOR

Council requires the proposal facilities to minimise and manage waste and recycling generated by the proposal.

- (1) A waste management plan for the work must be submitted to the principal certifying authority at least 2 days before work commences on the site
- (2) The waste management plan must—
 - (a) identify all waste (including excavation, demolition and construction waste materials) that will be generated by the work on the site, and
 - (b) identify the quantity of waste material in tonnes and cubic metres to be—
 - (i) reused on-site, and
 - (ii) recycled on-site and off-site, and
 - (iii) disposed of off-site, and
 - (c) if waste materials are to be reused or recycled on-site—specify how the waste material will be reused or recycled on-site, and
 - (d) if waste materials are to be disposed of or recycled off-site—specify the contractor who will be transporting the materials and the waste facility or recycling outlet to which the materials will be taken.
- (3) A garbage receptacle must be provided at the work site before works begin and must be maintained until the works are completed.
- (4) The garbage receptacle must have a tight fitting lid and be suitable for the reception of food scraps and papers.

5 RUN – OFF AND EROSION CONTROLS

Run-off and erosion controls must be implemented to prevent soil erosion, water pollution or the discharge of loose sediment on the surrounding land by—
diverting uncontaminated run-off around cleared or disturbed areas, and
erecting a silt fence and providing any other necessary sediment control measures that will prevent debris escaping into drainage systems, waterways or adjoining properties, and
preventing the tracking of sediment by vehicles onto roads, and
stockpiling top soil, excavated materials, construction and landscaping supplies and debris within the lot.

SCHEDULE 2B

DURING CONSTRUCTION/PRIOR TO OCCUPATION/COMPLETION

6 OCCUPATION CERTIFICATE TO BE SUBMITTED

An Occupation Certificate must be obtained from the Principal Certifier and a copy submitted to Council prior to commencement of occupation or use of the whole or any part of a new building, an altered portion of, or an extension to an existing building.

7 HOURS OF WORK AND NOISE

The hours of construction and work on the development must be as follows:

All work, including demolition, excavation and building work, and activities in the vicinity of the site generating noise associated with preparation for the commencement of work (eg loading and unloading of goods, transferring of tools etc) in connection with the proposed development must only be carried out between the hours of 7.00am and 7.00pm on Mondays to Fridays, inclusive, and 7.00am and 5.00pm on Saturdays, and no work must be carried out on Sundays or public holidays.

All work, including demolition, excavation and building work must comply with the Australian Standard 2436-2010 Guide to Noise Control on Construction, Maintenance and Demolition Sites.

Notwithstanding the above, the use of a crane for special operations, including the delivery of materials, hoisting of plant and equipment and erection, and dismantling of on site tower cranes which warrant the on- street use of mobile cranes outside of above hours can occur, subject to a permit being issued by Council under Section 68 of the Local Government Act 1993 and/or Section 138 of the Roads Act 1993.

Note: Works may be undertaken outside of hours, where it is required to avoid the loss of life, damage to property, to prevent environmental harm and/or to avoid structural damage to the building. Written approval must be given by the Construction Regulation Unit, prior to works proceeding.

The Council allows extended working hours subject to the approval of an application in accordance with the Code and under Section 4.55 of the Environmental Planning and Assessment Act 1979.

8 NOISE – DURING CONSTRUCTION

Construction noise

Noise caused by construction must not exceed an LAeq (15 min) of 5dB(A) above background noise when measured at any lot boundary of the property where the construction is being carried out.

9 ENCROACHMENTS – NEIGHBOURING PROPERTIES

No portion of the proposed structure shall encroach onto the adjoining properties.

10 DEMOLITION

Any demolition must be carried out in accordance with AS 2601—2001, The demolition of

Delegated report: DA 22/21 PAN159157 3 Woore Street, McIntyre Street Wilcannia

Page 25 of 30

structures.

11 MAINTENANCE OF SITE

All materials and equipment must be stored wholly within the work site unless an approval to store them elsewhere is held.

Waste materials (including excavation, demolition and construction waste materials) must be managed on the site and then disposed of at a waste management facility.

Copies of receipts stating the following must be given to the principal certifying authority—

the place to which waste materials were transported,

the name of the contractor transporting the materials,

the quantity of materials transported off-site and recycled or disposed of.

Any run-off and erosion control measures required must be maintained within their operating capacity until the completion of the works to prevent debris escaping from the site into drainage systems, waterways, adjoining properties and roads.

During construction—

all vehicles entering or leaving the site must have their loads covered, and all vehicles, before leaving the site, must be cleaned of dirt, sand and other materials, to avoid tracking these materials onto public roads.

At the completion of the works, the work site must be left clear of waste and debris.

12 EARTHWORKS, RETAINING WALLS AND STRUCTURAL SUPPORT

Any earthworks (including any structural support or other related structure for the purposes of the development)—

must not cause a danger to life or property or damage to any adjoining building or structure on the lot or to any building or structure on any adjoining lot, and must not redirect the flow of any surface or ground water or cause sediment to be transported onto an adjoining property, and

that is fill brought to the site—must contain only virgin excavated natural material (VENM) as defined in Part 3 of Schedule 1 to the Protection of the Environment Operations Act 1997, and

that is excavated soil to be removed from the site—must be disposed of in accordance with any requirements under the Protection of the Environment Operations (Waste) Regulation 2005.

Any excavation must be carried out in accordance with Excavation Work: Code of Practice (ISBN 978-0-642-785442 [PDF] and ISBN 978-0-642-785459 [DOCX]), published in July 2012 by Safe Work Australia.

13 ARCHAEOLOGY DISCOVERED DURING WORKS

If any object having interest due to its age or association with the past is uncovered during the course of the work—

all work must stop immediately in that area, and

the Office of Environment and Heritage must be advised of the discovery.

Note

Depending on the significance of the object uncovered, an archaeological assessment and excavation permit under the Heritage Act 1997 may be required before further the work can continue.

14 ABORIGINAL OBJECTS DISCOVERED DURING WORKS

If any Aboriginal object (including evidence of habitation or remains) is discovered during the course of the work—

all excavation or disturbance of the area must stop immediately in that area, and the Office of Environment and Heritage must be advised of the discovery in accordance with section 89A of the National Parks and Wildlife Act 1974.

Note—

If an Aboriginal object is discovered, an Aboriginal heritage impact permit may be required under the National Parks and Wildlife Act 1974.

15 COVERING OF LOADS

All vehicles involved in the excavation and/or demolition process and departing the property with demolition materials, spoil or loose matter must have their loads fully covered before entering the public roadway.

16 LOADING AND UNLOADING DURING CONSTRUCTION

The following requirements apply:

All loading and unloading associated with construction activity must be accommodated on site, where possible.

If, it is not feasible for loading and unloading to take place on site, a Works Zone on the street may be considered by Council.

A Works Zone may be required if loading and unloading is not possible on site. If a Works Zone is warranted an application must be made to Council at least 8 weeks prior to commencement of work on the site. An approval for a Works Zone may be given for a specific period and certain hours of the days to meet the need for the site for such facilities at various stages of construction. The approval will be reviewed periodically for any adjustment necessitated by the progress of the construction activities.

Where hoisting activity over the public place is proposed to be undertaken including hoisting from a Works Zone, a separate approval under Section 68 of the Local Government Act 1993 and Section 138 of the Roads Act 1993 must be obtained.

17 NO OBSTRUCTION OF PUBLIC WAY

The public way must not be obstructed by any materials, vehicles, refuse, skips or the like, under any circumstances. Non-compliance with this requirement will result in the issue of a notice by Council to stop all work on site.

18 USE OF MOBILE CRANES

The following requirements apply:

Mobile cranes operating from the road must not be used as a method of demolishing or constructing a building.

For special operations including the delivery of materials, hoisting of plant and equipment and erection, and dismantling of on site tower cranes which warrant the on-street use of mobile cranes, permits must be obtained from Council for the use of a mobile crane. The permits must be obtained 48 hours beforehand for partial road closures which, in the opinion of Council will create minimal traffic disruptions and 4 weeks beforehand in the case of full road closures and partial road closures which, in the opinion of Council, will create significant traffic disruptions.

The use of a crane for special operations, including the delivery of materials, hoisting of plant and equipment and erection and dismantling of on site tower cranes which warrant the on-street use of mobile cranes outside of approved hours of construction can occur, subject to a permit being issued by Council under Section 68 of the Local Government Act 1993 and/or Section 138 of the Roads Act 1993.

19 CONTAMINATED SOILS

Requirement to Notify about New Contamination Evidence

Any new information revealed during demolition works that has the potential to alter previous conclusions about site contamination or hazardous materials shall be immediately notified to the Council and the Principal Certifying Authority.

Reason: To protect human health and the environment.

Compliance with the Remediation Action Plan

The requirements of the Remediation Action Plan required by this consent are to be fully implemented from commencement of any excavation, demolition or development works until the issue of any interim / final occupation certificate.

Reason: Protection of the environment, SEPP 55 compliance.

A validation report, is to be prepared in accordance with relevant guidelines issued under the Contaminated Land Management Act 1997 must be submitted to the Council within one month from completion of the remediation work.

Details demonstrating compliance are to be submitted to the Certifying Authority prior to the issue of any interim / final Occupation Certificate.

If the site requires ongoing activities to control contamination, the validation report is to provide a list of ongoing measures to be undertaken to protect adjacent properties, the environment and the water table from further contamination.

Reason: To ensure environmental amenity is maintained.

20 VEHICULAR ACCESS

If the work involves the construction of a vehicular access point, the access point must be completed before the occupation certificate for the work on the site is obtained.

21 UTILITY SERVICES

If the work requires alteration to, or the relocation of, utility services on, or adjacent to, the lot on which the work is carried out, the work is not complete until all such works are carried out.

IMPORTANT ADDITIONAL INFORMATION

Advisory notes:

The Environmental Planning and Assessment Act 1979 requires you to:

Obtain a Construction Certificate prior to the commencement of any works. An application may be lodged through the NSW Planning Portal to Council, or you may apply to a private accredited certifier (through the NSW Planning Portal) for a Construction Certificate. An accredited certifier must obtain Council's approval to certain conditions of this development consent, where indicated before issuing the Construction Certificate.

Note: it is compulsory to lodge digital copies of applications, including plans and documentation if lodging an application through the NSW Planning Portal with Council. Please refer to the link below for any further information about digital requirements and electronic files.

Nominate a Principal Certifier which may be either Council or an accredited certifier and notify Council of that appointment. You cannot lawfully commence works without complying with this requirement.

Give Council at least two days' notice of your intention to commence the erection of a building before commencing construction works. You cannot lawfully commence works without complying with this requirement.

Obtain an Occupation Certificate before commencing occupation or commencing to use the building or on the completion of other works including the erection of a sign. You cannot lawfully commence occupation or the use of a building without complying with this requirement.

You may also need to:

Obtain approval through the lodgement of an application under Section 68 of the Local Government Act 1993 and Section 138 of the Roads Act 1993 for an activity which is proposed to be undertaken in, on or above a road reservation (including footways). Such activities include:

- a) Installation of hoardings/scaffolding.
- b) installation and/or alterations to advertising/business signs and street awnings.
crane operation and other hoisting activities.
- c) temporary works (e.g.: barricading, road openings, mobile hoisting devices).
works zone (for loading and unloading from the roadway); and
- d) temporary ground anchoring and shoring to support a roadway when excavating.

Lodge an Application for Subdivision to obtain a Subdivision Certificate if a land (including stratum) subdivision is proposed and an Application for Subdivision to obtain Strata Title Subdivision under the relevant Strata Titles Act if strata title of the development is proposed.

Comply with the Food Act 2003, the Australia New Zealand Food Standards Code, Australian Standard 4674 – 2004, and register the business with Council if the premises are used for the manufacture, preparation, packing, storing, conveying, or delivering of food or beverage for sale.

Contact Central Darling Shire Council regarding the water and sewerage services to this development.

Carry out critical stage inspections in accordance with Section 6.5 of the EP&A Act 1979 and clauses 162A, 162B and 163 of the EP&A Regulation 2000.

Applications and submissions referred to in this consent may be lodged at: Central Darling Shire Council
21 Reid Street
Wilcannia NSW 2836