

- EX -- EXISTING RL (SURVEY)
- PRO -- PROPOSED RL
- EST -- ESTIMATED RL (EXTRAPOLATED)
- G -- GENTLE RISE IN LANDSCAPE LEVEL
- STEP (XX mm)
- EXISTING ELEVATION
- PROPOSED ELEVATION

### WALL LEGEND

- NEW CONSTRUCTION
- EXISTING WALL
- RAMMED EARTH

### Room Schedule - Ground Floor

Number	Name	Area
1	ENTRY FOYER	32.2 m <sup>2</sup>
2	TOURIST INFORMATION/MERCHANDISE	49.9 m <sup>2</sup>
3	COMMERCIAL KITCHEN	15.8 m <sup>2</sup>
4	KEEPING PLACE ANNEX/ ARCHIVE EXAMINATION AREA	14.0 m <sup>2</sup>
5	MEN'S KEEPING PLACE	13.9 m <sup>2</sup>
6	WOMEN'S KEEPING PLACE	13.7 m <sup>2</sup>
7	MALE TOILETS	9.1 m <sup>2</sup>
8	ACCESS TOILET/SHOWER	6.7 m <sup>2</sup>
9	FEMALE TOILETS	11.7 m <sup>2</sup>
10	RESOURCE LIBRARY	41.7 m <sup>2</sup>
11	EXHIBITION SPACE/MULTI-PURPOSE	192.3 m <sup>2</sup>
12	OFFICE	31.4 m <sup>2</sup>
13	SECURE CORRIDOR	30.9 m <sup>2</sup>
14	KEEPING PLACE ENTRY	22.3 m <sup>2</sup>
15	STUDIO/WORKSHOP (EXISTING BUILDING)	68.7 m <sup>2</sup>
16	MALE CHANGING ROOM	10.0 m <sup>2</sup>
17	OUTDOOR WAITING AREA	22.6 m <sup>2</sup>
18	FEMALE CHANGING ROOM	9.8 m <sup>2</sup>
20	KEEPING PLACE	81.0 m <sup>2</sup>
		678.0 m <sup>2</sup>

### GENERAL ABBREVIATIONS

ABBR	DESCRIPTION
EF-5	CAST IRON POST
EWH	ELECTRICAL WATER HEATER
FEN-1	PLANTROOM ENCLOSURE, SCAVENGER SUPPLIES 50 X 50 X 13 MESH
MCC	MECHANICAL DISTRIBUTION BOARD
MDB	MAIN DISTRIBUTION BOARD
MTP	METER PANEL
RWT	RAIN WATER TANK

- NEW TREES
- EXISTING TREE TO RETAINED
- EXISTING TREE TO BE REMOVED

CODE TREES	BOTANICAL NAME	COMMON NAME	MIN POT SIZE	COUNT
------------	----------------	-------------	--------------	-------

JAC mim	Jacaranda mimosifolia	Jacaranda	200L	1
EUC cam	Eucalyptus camaldulensis	Red River Gum (Canoe Tree)	200L	5
BRA ace	Brachychiton acerifolius	Illawarra Flame Tree	100L	1
ACA ste	Acacia stenophylla	River Cooba, Native Willow, River Myall, Eumong		2
PIT ang	Pittosporum angustifolium	Weeping Pittosporum, Native Plum, Gumby Gumby, Butterbush	100L	3
ACA ane	Acacia aneura	Mulga	100L	1
CAP mit	Capparis mitchellii	Wild Orange	100L	1
EUC lar	Eucalyptus largiflorens	Black Box	100L	1
SAN acu	Santalum acuminatum	Sweet Quandong	200L	2

### SHRUBS, GROUND COVER AND CREEPERS

ATR num	Atriplex nummularia	Old Man Saltbush		103m <sup>2</sup>
ERE lon	Eremophila longifolia	Emu Bush		9.5m <sup>2</sup>
ENC tom	Enchylaena tomentosa	Ruby Saltbush		11m <sup>2</sup>
TRA jas	Trachelospermum jasminoides	Jasmine Star		36 m+30m <sup>2</sup>
EXO aph	Exocarpos aphyllus	Leafless Ballart	45L	1
ERE stu	Eremophila sturtii	Turpentine Bush		
SOL stu	Solanum Sturtianum	Thargomindah Nightshade		5.5m <sup>2</sup>
MAR aus	Marsdenia australis			3
SWA for	Swainsona formosa	Sturt's Desert Pea		12m

### GRASSES

GRA glo	Craspedia globosa	Native Daisy, Billy Buttons Yellow		64
ANI man	Anigozanthos manglesii	Red and Green Kangaroo Paw		51
LOM sil	Lomandra Silver Grace	Mat Rush		116
BOT mac	Bothriochloa macra	Red Grass		138m <sup>2</sup>
TRI sca	Triodia scariosa	Porcupine Grass		2 m <sup>2</sup>
CYM amb	Cymbopogon ambiguus	Lemon Grass, Scent Grass		2 m <sup>2</sup>

### PLANTS IN ASSORTED GARDEN BED

ABB	BORANICAL NAME	COMMON NAME	COUNT
CRI fla	Crinum flaccidum	Darling lily	x3
POR ole	Portulaca oleracea	Pigweed	x3
MEN aus	Mentha australis	Native mint	x3
SAR pra	Sarcococa praecox	Pigface	x3
SWA for	Swainsona formosa	Sturt's Desert Pea	x9
TET moo	Tetragonia moorei	Wild Spinach	x3
TRI sua	Trigonella suavissima	Cooper's Clover	x3
MIC lan	Microseris lanceolata	Native Yam, Yam Daisy, Murnong	x3
POL stu	Polycalymma sturtii	poached egg daisy	x3

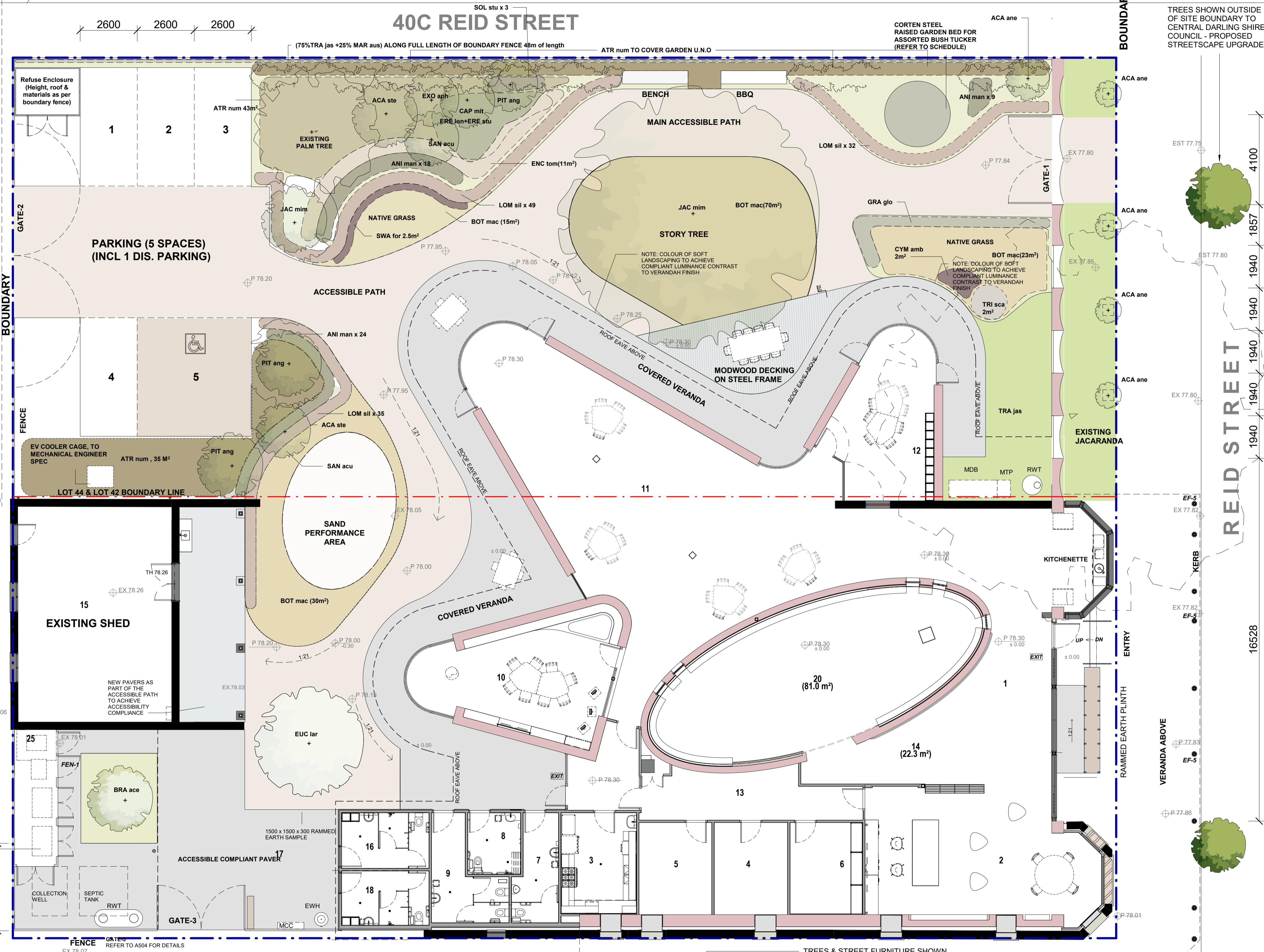

- NOTE:
- ALL PLANTING AREAS TO HAVE 300mm OF IMPORTED TOP SOIL
  - CORTEN STEEL EDGING TO PERIMETER OF SAND PERFORMANCE AREA AND NATIVE GRASS AREA 2.0 mm 150mm HIGH
  - PROVIDE STREET TREE GRATES TO ALL STREET TREES
  - DIG CAREFULLY TO EXISTING FOOT PATH AND INSTALL ADEQUATE SOIL AND SUBSTRATES FOR TREES TO GROW TO MATURITY

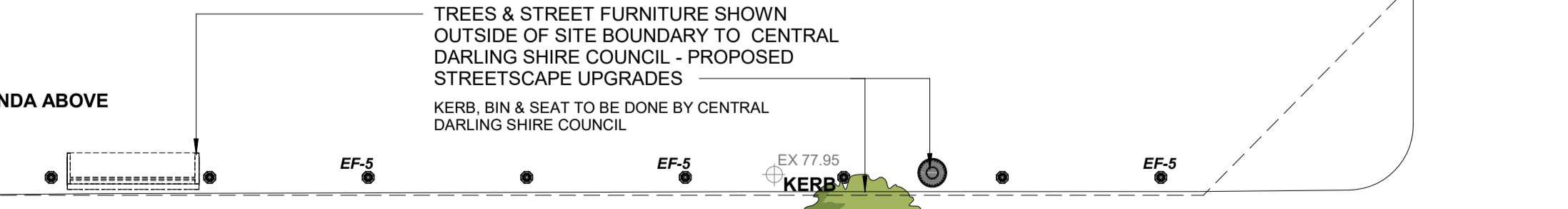

### FOR APPROVAL

**DISCLAIMER**  
Copyright in all documents and drawings prepared by KAUNITZ YEUNG ARCHITECTURE and any works executed from those documents and drawings shall remain the property of or on creation vest in KAUNITZ YEUNG ARCHITECTURE Pty Ltd.  
All information illustrated on this document is to be checked and verified on site.  
In the event of discrepancies refer to architect prior to commencement of the work.  
Do not scale drawings manually or electronically.

**DATE**  
20/04/2023  
28/04/2023  
10/05/2023  
07/06/2023

**REV**  
DA12  
DA13  
M  
DA14

**ISSUE**  
FOR APPROVAL  
FOR APPROVAL  
TENDER AMENDMENT  
DA AMENDMENT

**CHECKED BY**  
KYA  
KYA  
KYA  
KYA

**PROJECT NAME:** BAAKA CULTURAL CENTRE WILCANNIA  
44 Reid St, Wilcannia NSW 2836, Australia

**KAUNITZ YEUNG ARCHITECTURE**  
Level 3, 63 William St Darlinghurst  
T +61 2 9007 2098

**NO** DA107  
**REV** DA14  
**TITLE** PROPOSED GROUND FLOOR PLAN  
**PHASE** DA  
**SCALE** As indicated @ A1  
**DATE** 07/06/2023

1:100 @ A1