

PROPOSED SUBDIVISION OF LOTS 6 & 7 OF SECTION 14 IN D.P. 758669

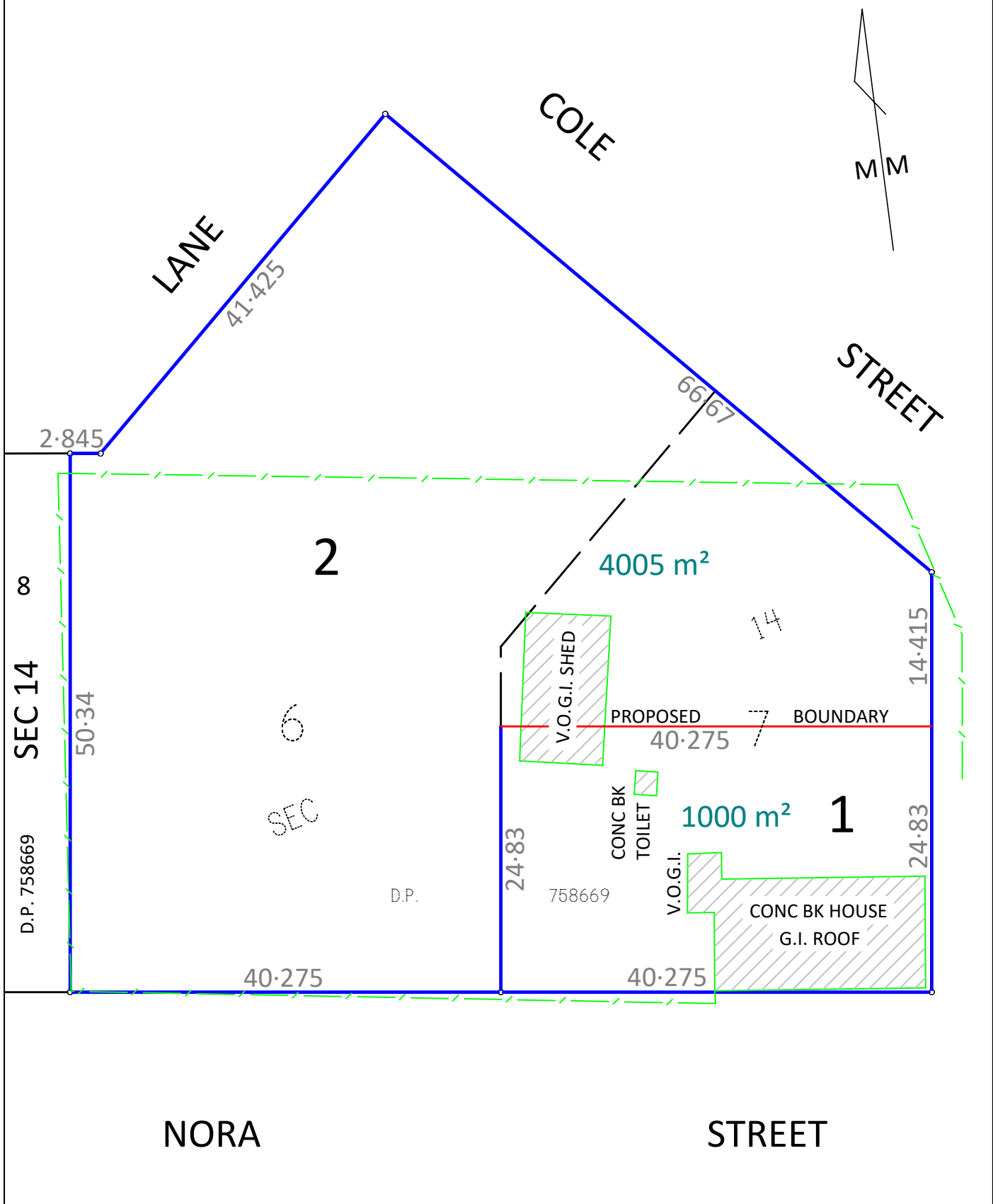

NOTE: MEASUREMENTS ARE SUBJECT TO FINAL PRESENTATION

LAND AT MENINDEE
PARISH OF PERRY

LOCAL GOVERNMENT AREA: CENTRAL DARLING
COUNTY OF MENINDEE

LENGTHS ARE IN METRES

GRAHAM F. HOWE
REGISTERED SURVEYOR
PH/FAX 08 8087 3660
515 WYMAN LANE, BROKEN HILL
P.O. BOX 317 N.S.W. 2880

SIGNED:

SCALE 1:500 (A4)

30-7-2021

T15-12P